

Aprobat  
PRIMAR  
ing Muresan Ioan Florin



## ANTEMASURATOARE

Hidroizolatie cu membrana speciala tip SIKA a terasei cladirii primariei Baciu. Suprafata totala a terasei 211 mp.

1, Desfacere gresie si plinta	225 mp
2, Decapare sapa veche	211 mp
3, Transport moloz	20 to
4, Amenajare suprafata	250 mp
5, Hidroizolatie cu membrana SIKA	250 mp
6, Turnat beton cu nisip de quart	7,5 mc
7, Elicopterizare beton	250 mp
8, Pompare beton	7,5 mc
9, Transport beton	2 curse la 10 km
10, Transport materiale	2 curse la 10 km

Intocmit

Ing. Kovacs Gyorgy

A handwritten signature in blue ink, appearing to be 'Gyorgy Kovacs', written over the printed name.

PLAN TERASA.

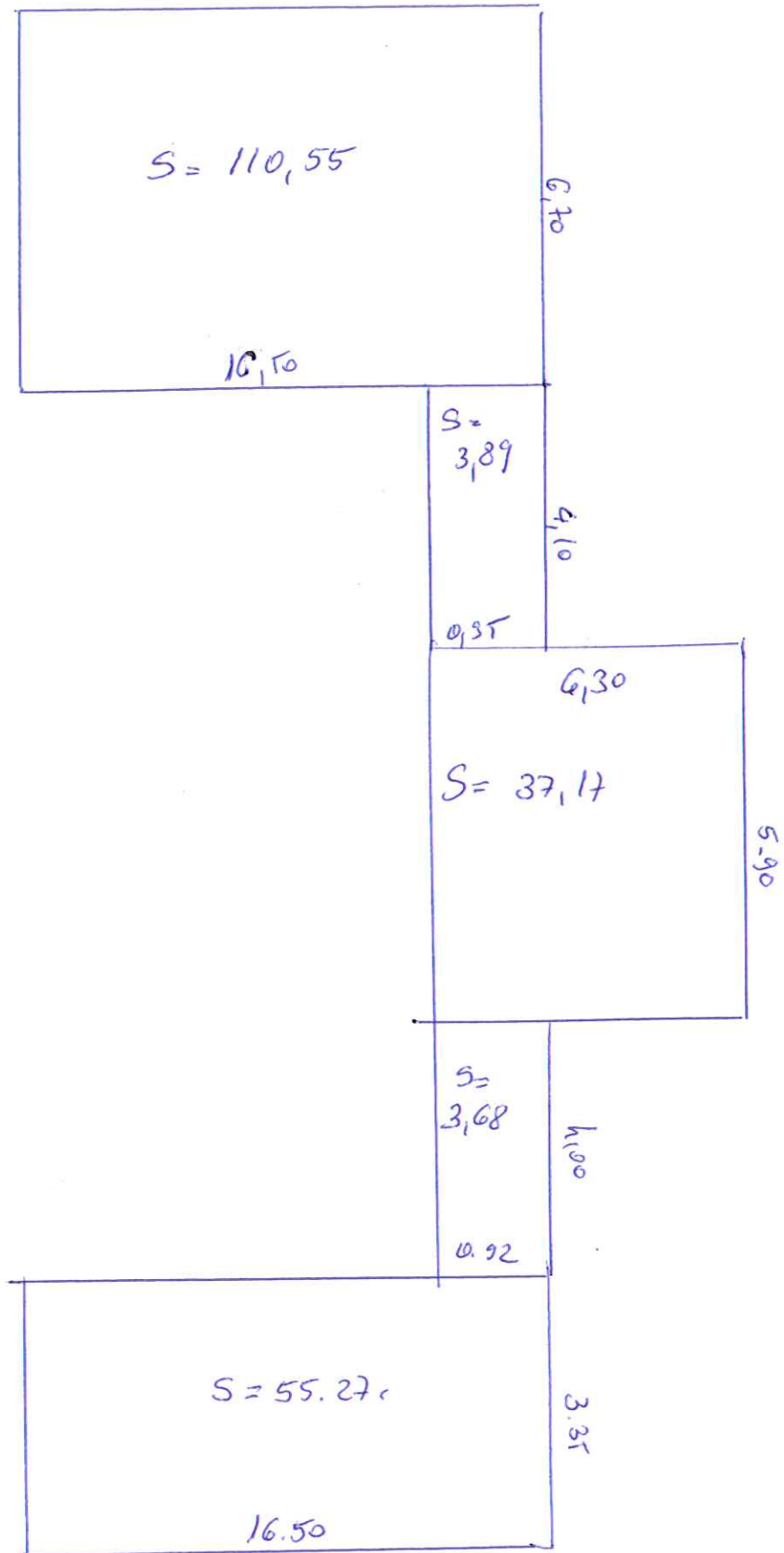

TOTAL = ~~211~~ + 39 = 250 mp.